

## Other products from GSD

### “Wireless Network System”

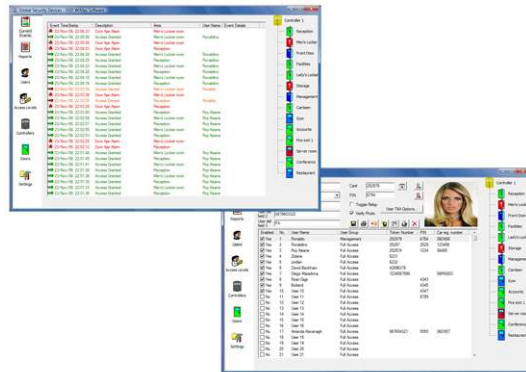

**GSD Wi-Enterprise/Wi-Plus System** is the next generation in access control solutions. It provides a Wireless Network throughout the premises, giving the convenience and security of a fully networked system for a fraction of the cost.



For more information on the Wireless Network System visit our website [www.globalsecurity.ie](http://www.globalsecurity.ie)

## Contents

Operation Instructions 2

Installation Diagrams 6

Wiring Diagrams 8

Quick Reference 17

Administration Notes 18



**GSD** 2 Door Pin and Proximity

## Technical Specs

Power Supply	12 - 24V AC or DC
Current consumption	100mA
Current consumption with load (max)	130mA
Relay Contact Rating	5 Amps / 240V ac
Operating Temperature	- 20° C to +60° C
Moisture Resistance	IP 67
Dimensions - Flush Mount	W. 87mm D. 21mm H. 119mm
- Surface Mount	W. 87mm D. 35mm H. 119mm
Number of Users	1000

## Factory Default PIN codes

The following PIN codes are the Factory Default Settings:

- User PIN '1111' will grant access on door 1
- User PIN '2222' will grant access on door 2
- The Default Engineer code is '6666'

Note: These User PINs ('1111', '2222') are deactivated when the first User PIN is added to the keypad.

## Restoring Factory Settings

Code	Description
55	Restore Factory Default Settings

Example:



Note: If Engineer code is lost, Remove the Security Caps (see page 11) and hold down the X key during power-up and enter the default Engineer code '6666' immediately. This will restore the factory settings.

## Adding and Removing User PINs

Code	Description
01	Add a Standard User/Toggle User/Manager User PIN to Door 1
02	Add a Standard User/Toggle User/Manager User PIN to Door 2
03	Remove any User PIN

Example: To Add User PIN '5656' to Door 1..



Example: To Remove User PIN '4545' from any door..



Example: To Add Toggle User PIN '1234' to Door 2..



Example: To Add Manager User PIN '5678' to Door 2..



## Adding a Batch of Cards or Fobs

Code	Description
04	Add Batch of Standard Cards/Toggle Cards/Manager Cards Door 1
44	Add Batch of Standard Cards/Toggle Cards/Manager Cards Door 2

Example: To Add a Single Standard Card...

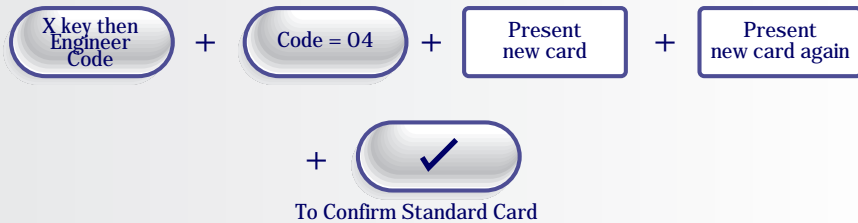

Example: To Add a Batch of Standard Cards...

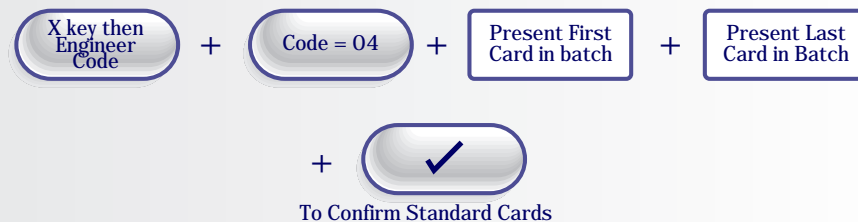

Example: To Add a Batch of Toggle Cards...

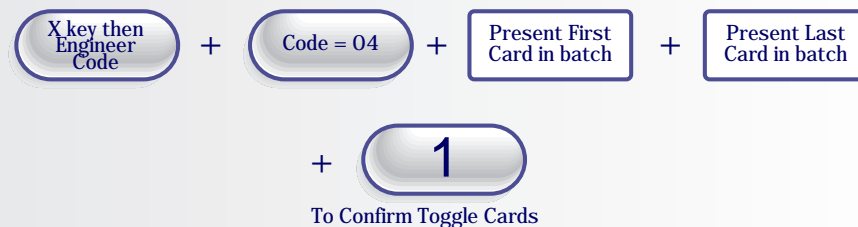

Example: To Add a Batch of Manager User Cards...

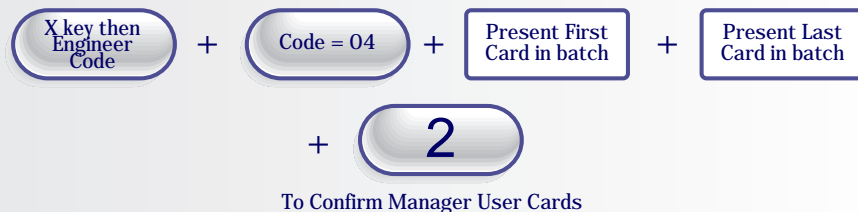

## Adding User Cards or Fobs using Keypad

Code	Description
06	Add Batch of Cards using Keypad Door 1
46	Add Batch of Cards using Keypad Door 2

Example: To Add a Single Standard Card... (Card number = 00001234)

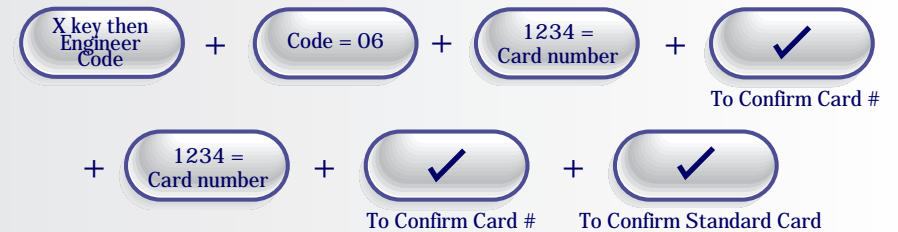

Example: To Add a Batch of Standard Cards... (Batch = 0000200 to 0001000)

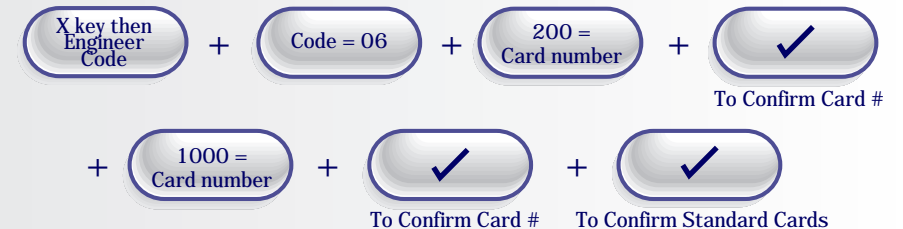

Example: To Add a Batch of Toggle Cards... (Batch = 0003200 to 0004000)

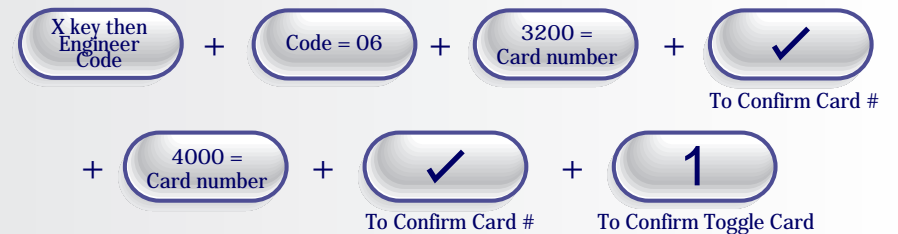

Example: To Add a Batch of Manager User Cards... (Batch = 001200 to 001250)

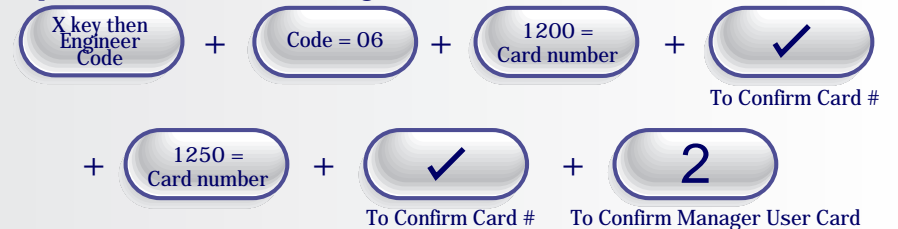

## Adding a Card and PIN

Code	Description
07	Add a Card and a User PIN Door 1
47	Add a Card and a User PIN Door 2

Example: To Add a Card & PIN... (Card number = 00001234, PIN = 4444)

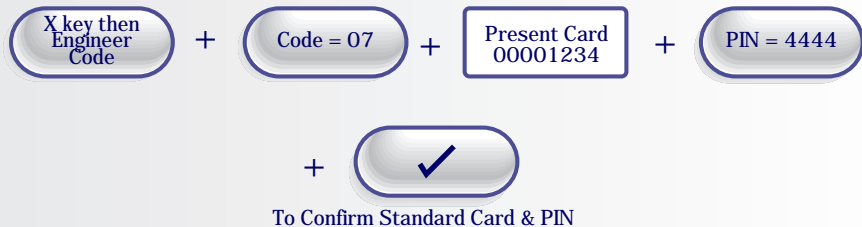

Example: To Add a Toggle Card & PIN... (Card number = 00001234, PIN = 4444)

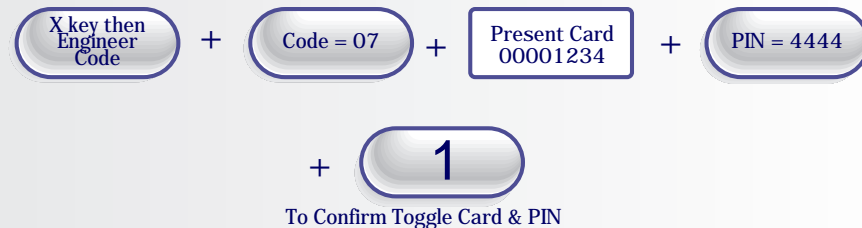

Example: To Add a Mgr User Card & PIN... (Card number = 00001234, PIN = 4444)

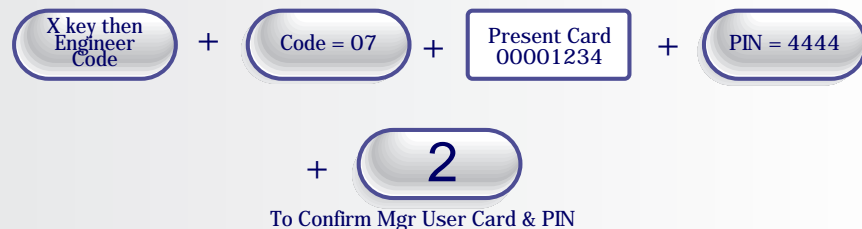

## Removing a Batch of Cards or Fobs

Code	Description
05	Removing a Batch of Cards

Example: To remove a Single Card...

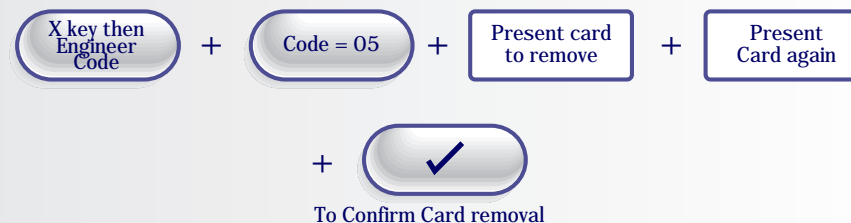

Example: To Remove a Batch of Cards...

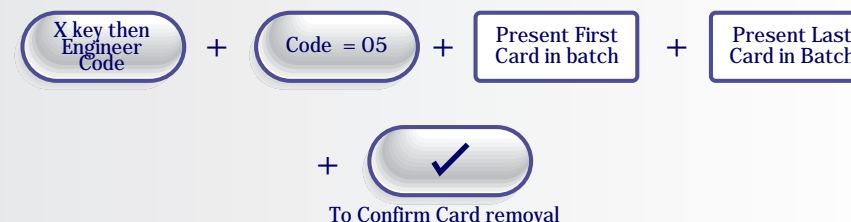

## Removing a Card and PIN

Code	Description
08	Removing a Card (and any associated PIN)
09	Removing a Card (and any associated PIN) using Keypad

Example: To Remove a Card...

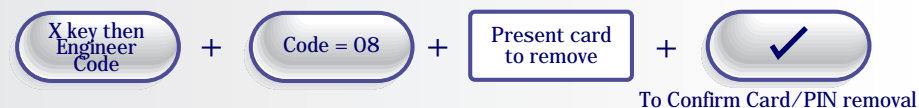

Example: To Remove a Card using Keypad... (Card number = 00001234)



## Changing Relay Times and Engineer Codes

Code	Description	Default Settings
10	Change the Number of PIN Digits	4 digit PIN (4,5,6 only)
11	Change the Engineer Code	6666
12	Change the Relay Active Time Door 1	5 seconds (0-255)
13	Change the Door Ajar Time	30 seconds (2-255)
14	Change the Guest Buzzer Time	3 seconds (1-10)
15	Change the Relay Active Time Door 2	5 seconds (0-255)

Note: The Number of PIN digits can not be reduced once a User Pin has been added.

Example: To Change the Engineer Code..

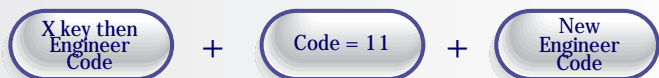

Example: To Change the Relay Active Time to 14 seconds..



Example: To Change the Relay Active Time to a 200msec pulse..



## Changing Input/Output Options

Code	Description
30	Change the Input and Output Options

Example:

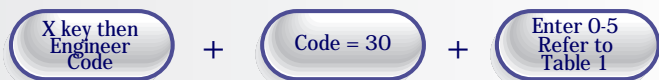

Table 1

Option	Input 1	Input 2	Input 3	Output 1	Output 2	Wiring Diagrams
0 Default	Door 1 Exit Button	Door 1 Contact	Interlock I/P	Alarm/Buzzer	Interlock O/P	Page 12
1	Door 1 Exit Button	Door 1 Contact	Interlock I/P	Follow Relay 1	Interlock O/P	Page 12
2	Door 1 Exit Button	Door 1 Contact	Alarm Panel I/P	Alarm/Buzzer	Alarm Panel O/P	Page 13
3	Door 1 Exit Button	Door 1 Contact	Fire Alarm Override	Follow Relay 1	Alarm/Buzzer	Page 14
4	Door 1 Exit Button	Door 1 Contact	Door 2 Exit Button	Follow Relay 1	Alarm/Buzzer	Page 15
5	Door 1 Exit Button	Door 1 Contact	Door 2 Exit Button	Follow Relay 1	Follow Relay 2	Page 15

## Turning Features ON or OFF

Code	Description	Default Settings
20	Set Silent Operation on/off	Off
21	Set Ajar Alarm on/off	On
22	Set Guest Button on/off	On
23	Set Duress codes on/off	Off
24	Set Toggle Relay on/off	On
25	Set Door Forced Alarm on/off	On
26	Set Anti-Tail Gate on/off	Off
27	Set Constant Backlight on/off	On
28	Set Invalid PIN Lockout on/off	On (3 Retries)
31	Set Card Or PIN on/off	On
32	Set Card And PIN on/off	Off
33	Set Card And Any PIN on/off	Off

Note: 0 = Off 1 = On

Example: To Set the Backlight to always stay ON...

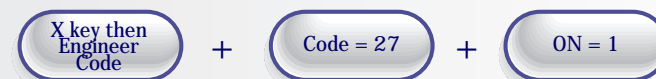

Example: To Set the Backlight to stay ON for 10 seconds only after a key press...

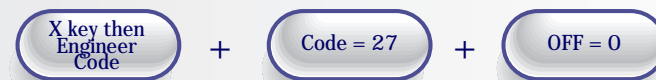



Fix Surface Mount Collar to wall, ensure arrow is pointing upwards

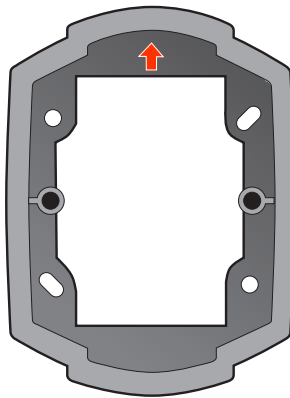

### Surface Mounting

Fix Surface Mount Collar to wall (as above). After wiring is complete, Keypad may then be screwed to Surface Mount Collar using security screws provided. Both Security Caps are then clipped onto keypad.

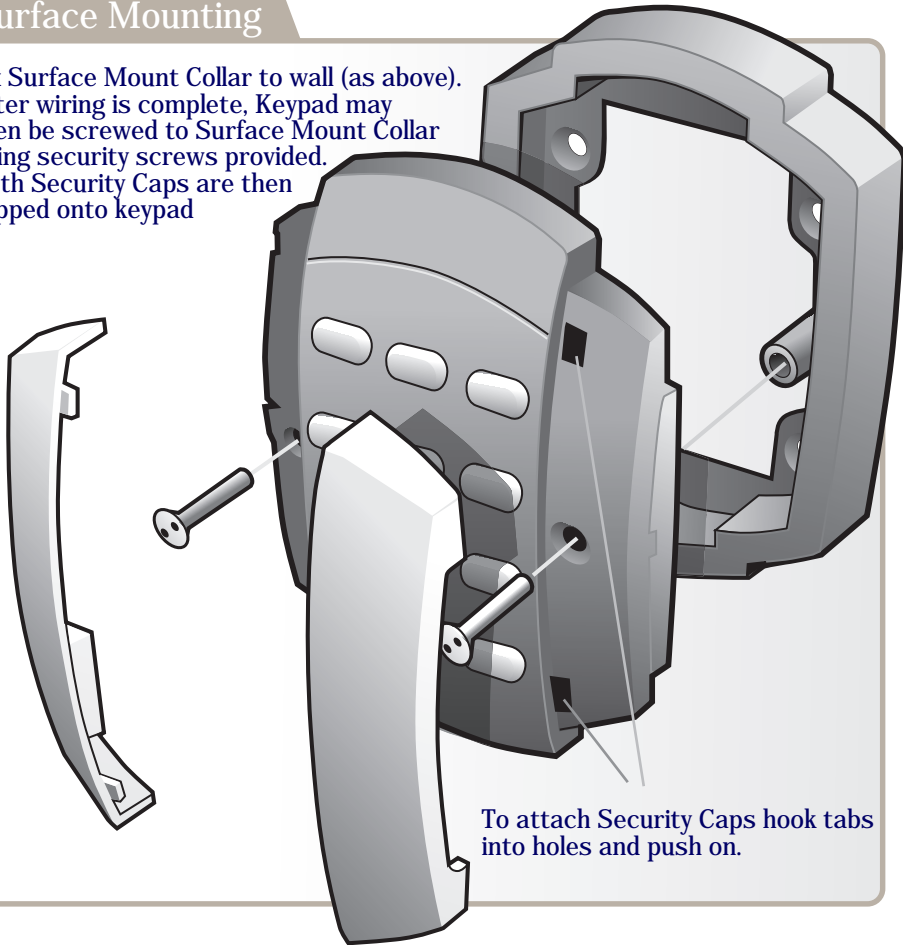

To attach Security Caps hook tabs into holes and push on.

### Flush Mounting

Keypad is mounted to pattress box using security screws provided. Both Security Caps are then clipped onto Keypad.

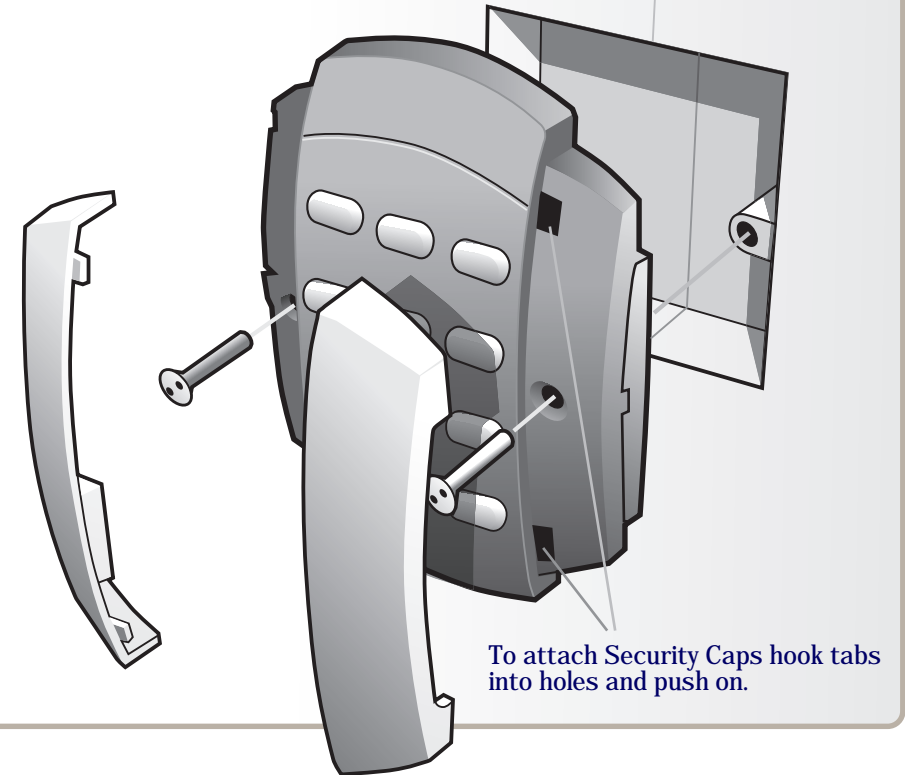

To attach Security Caps hook tabs into holes and push on.

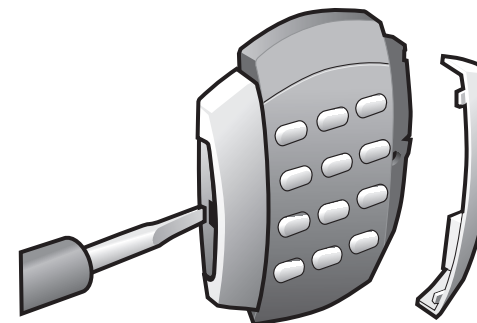

To release Security Caps push a screwdriver into slots on the side and pull forward.

## Interlock Connections for Door 1

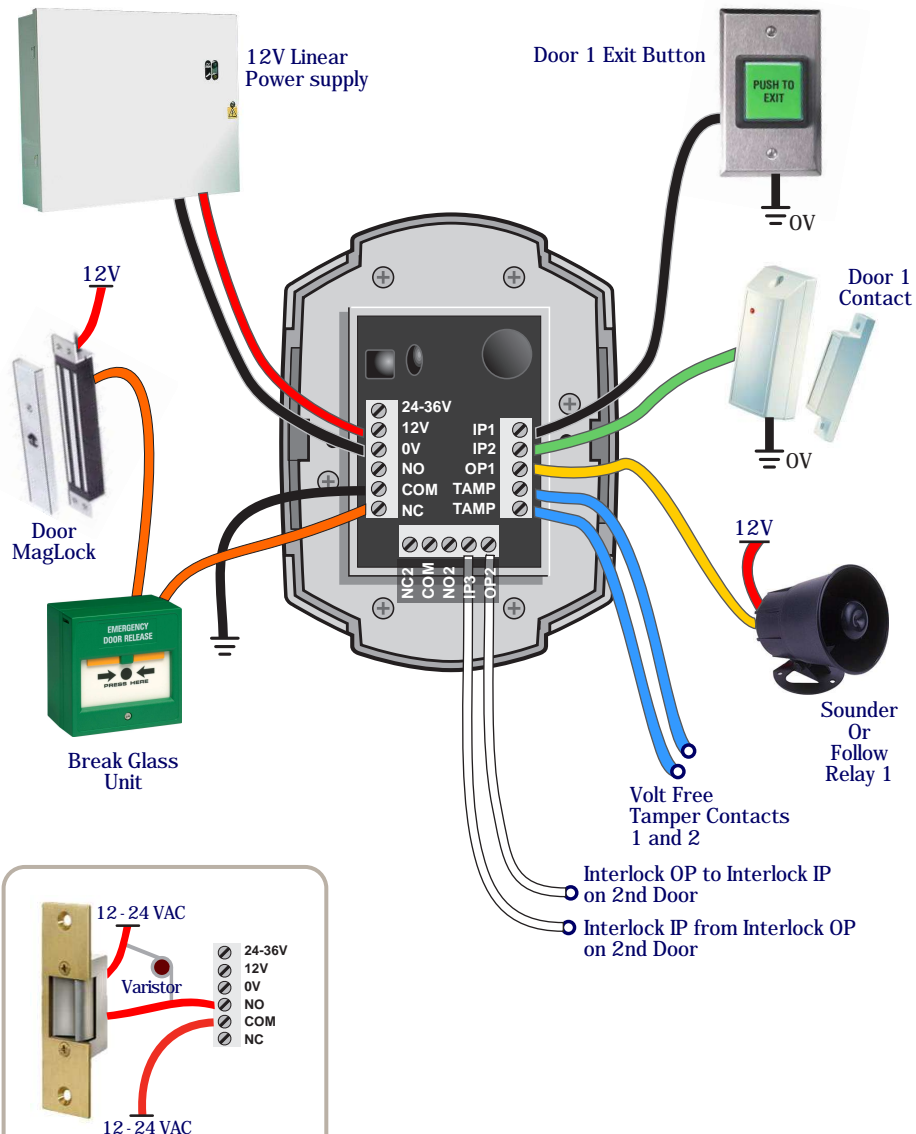

Wiring for StikeLock only using 12 - 24VAC supply



Note: All 0V shown in the diagram are connected to 0V at the back of the keypad terminal block.

## Alarm Panel Connections for Door 1

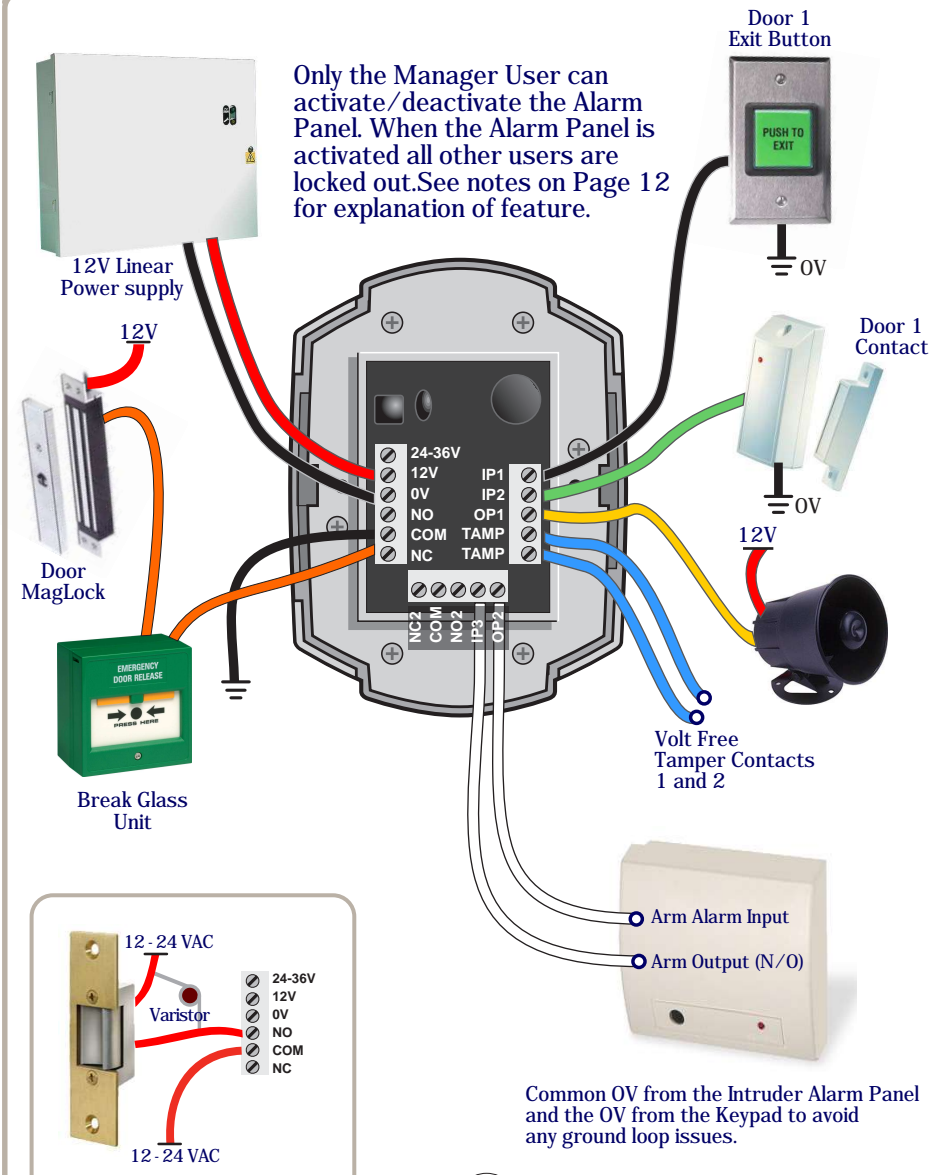

Wiring for StikeLock only using 12 - 24VAC supply



Common 0V from the Intruder Alarm Panel and the 0V from the Keypad to avoid any ground loop issues.

# Fire Alarm Override for Door 1

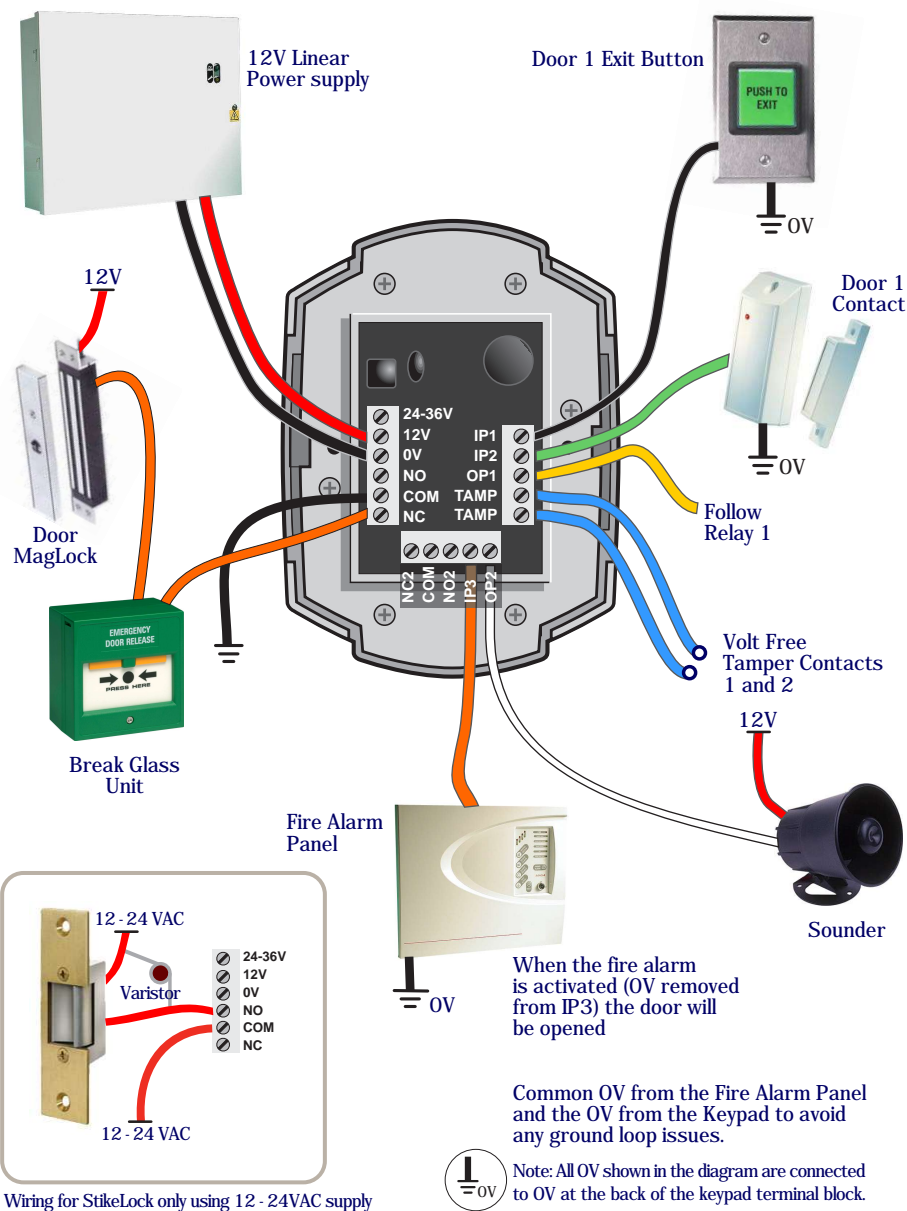

# Door 1 and Door 2 connections

